

2021 SHOCKWAVE TOY HAULERS

SHOCKWAVE



SPORT SERIES



24FS

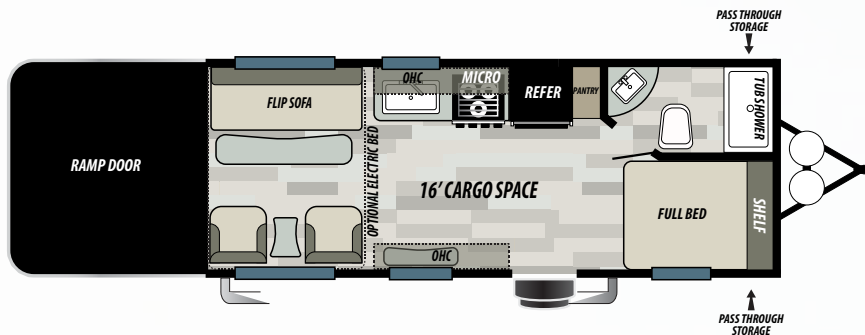

18FS

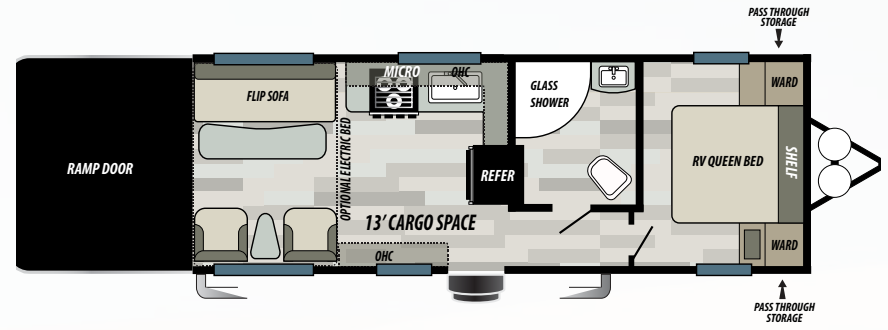

24FS

SPORT SERIES STANDARDS

- HEATED & ENCLOSED TANKS
- WATER HEATER BYPASS
- RV QUEEN MATTRESS (24FS MAIN BED)
- 86 GAL FRESH WATER
- DUCTED 13.5 BTU AIR CONDITIONER
- 3 BURNER COOK TOP WITH GLASS FRONT 17" OVEN
- 2 CHAIRS WITH 1 SOFA & TABLE
- 6 GAL G/E DSI WATER HEATER
- POWER AWNING W/ LED LIGHT STRIP
- FULL LENGTH WALK ON ROOF
- ONE PIECE SEAMLESS PVC ROOF
- DRIVE ON WHEEL WELL (DOORSIDE)
- 102" WIDE BODY CONSTRUCTION W/ 8" I-BEAM
- 3,000 LB GREY RADIUS RAMP DOOR
- 1,200 LB TIE DOWNS MOUNTED TO STEEL
- 5,100 LB AXLES W/ SELF ADJUSTING BRAKES

- 2- 20 LB LPG BOTTLES W/ COVER
- BLACK STEEL WHEELS
- COLORED METAL FRONT WRAP
- LED INTERIOR LIGHTS
- BLACK CHEF'S HIGH-RISE SPRING FAUCET
- 30,000 BTU DUCTED FURNACE
- FOOT FLUSH TOILET
- SAFETY GLASS WINDOWS
- CONTROL PANEL
- RADIUS GLASS SHOWER WITH SURROUND (24FS)
- BATTERY DISCONNECT
- STORAGE SHELF OVER PRIMARY BED
- REAR SPOILER
- MIRRORED MEDICINE CABINET
- DESIGNER SPORT SERIES FURNITURE
- RADIUS EDGE THERMO FOIL COUNTERTOPS
- 8 CU FT DOUBLE DOOR REFER

SPORT SERIES OPTIONS

- RAMP DOOR PATIO CABLE KIT
- DUAL 30 LB LP BOTTLES (IPO 20 LB)
- A/C 15,000 BTU UPGRADE
- RETRACTABLE ROOF LADDER
- ARCTIC PACKAGE - RADIANT FOIL INSULATION FLOOR & ROOF
- 170W SOLAR PANEL W/REGULATOR

SPORT SERIES ENTERTAINMENT PACK

- BLUETOOTH STEREO W/ INTERIOR & EXTERIOR SPEAKERS
- TV ANTENNA W/ BOOSTER
- ELECTRIC CHARGING STATIONS

	18FS	24FS
HITCH WEIGHT (LBS.)	760	871
GROSS VEHICLE WEIGHT RATING (LBS.)	9,999	9,999
UNLOADED VEHICLE WEIGHT (LBS.)	5,850	6,251
CARGO CARRYING CAPACITY (LBS.)	4,149	3,748
EXTERIOR LENGTH (FT.)	25' 10"	29' 10"
EXTERIOR HEIGHT (FT.)	12' 1"	12' 1"
FRESH WATER (GAL.)	80	80
GREY WATER (GAL.)	40	40
BLACK WATER (GAL.)	35	40

TRAVEL TRAILERS





26QSGDX

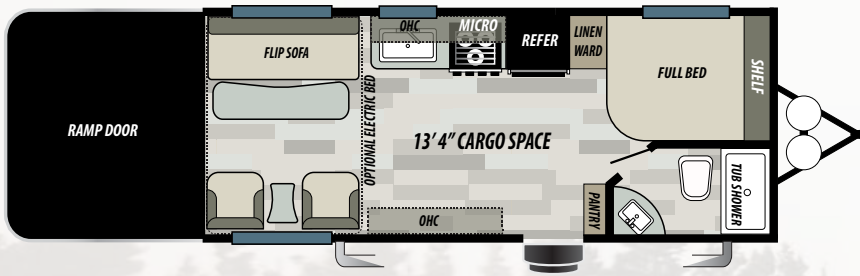

18CBMX

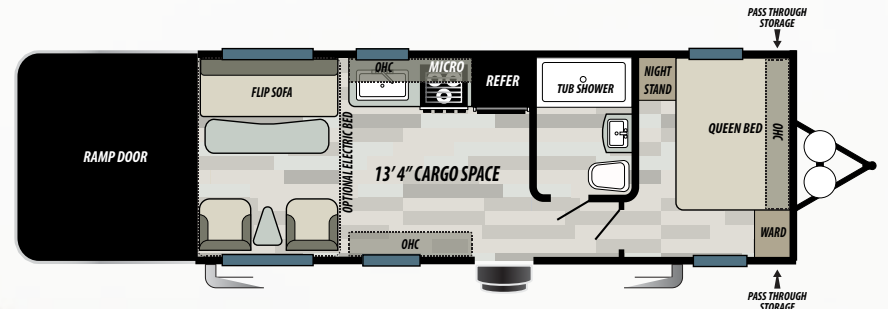

21RQMX

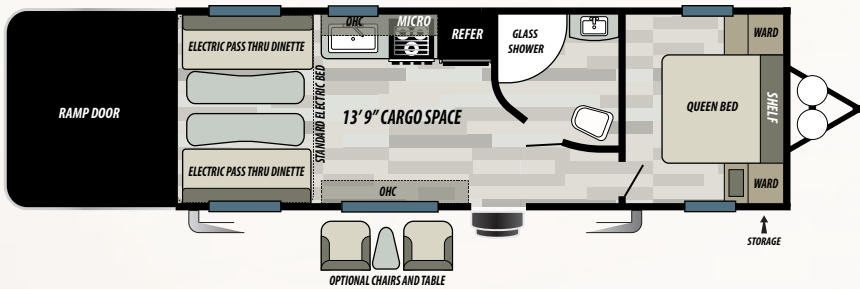

24RQMX/24RQGMX

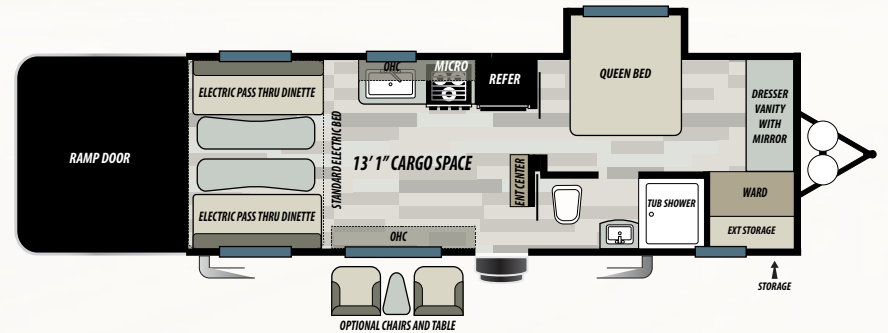

24QSGMX

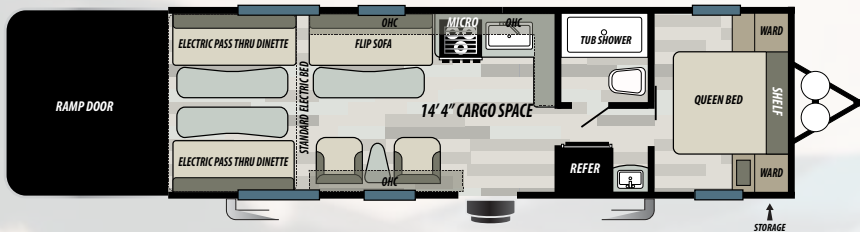

25RQMX/25RQGMX

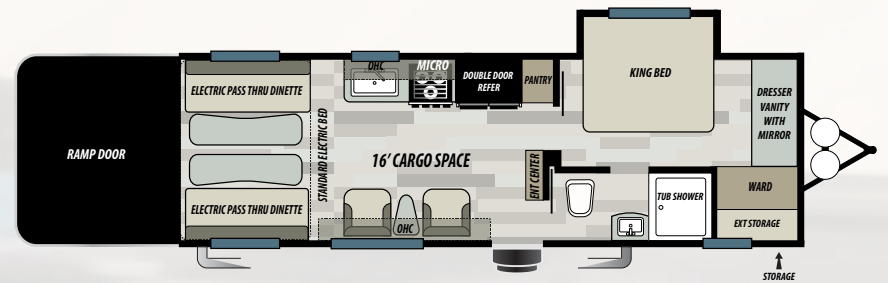

26QSGDX

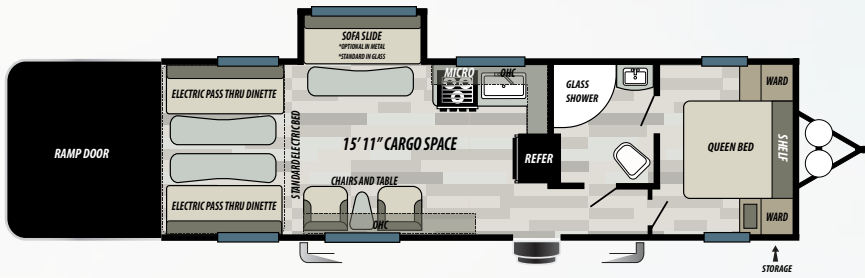

27RQMX/27RQGDX

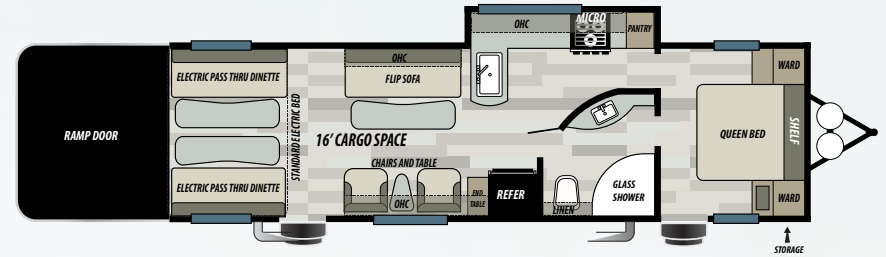

29RQMX/29KSGDX

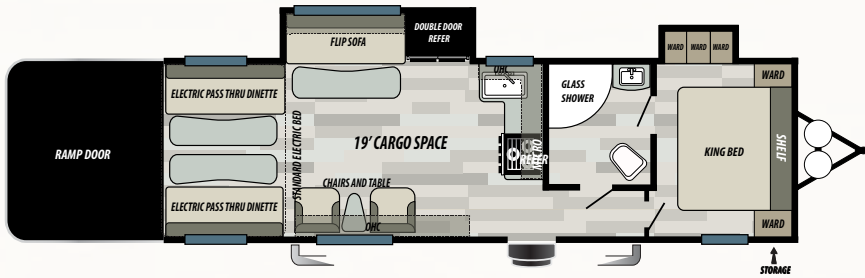

30FKGDX

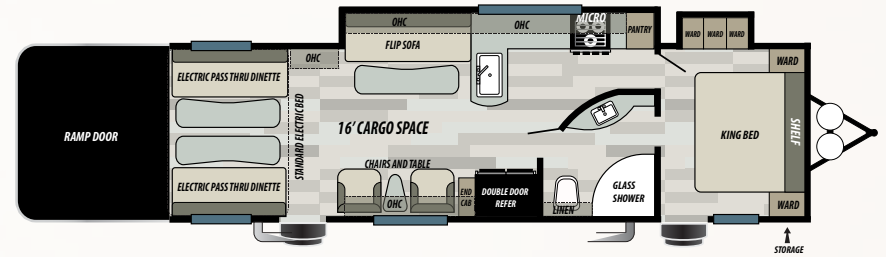

30DSGDX

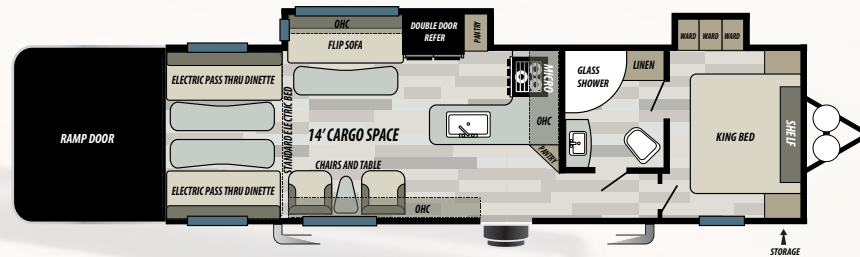

31KSGDX



26QSGDX FEATURING 12.3 CU FT G/E REFRIGERATOR

EMBROIDERED CHAIRS

FIFTH WHEELS

FIFTH WHEEL STANDARDS

WAINECOTING IN CARGO AREA
 RESIDENTIAL 72" X 80" KING BED W-DRAWER
 BLACK CABINET & DOOR HARDWARE
 FRICTIONHINGE ENTRY DOOR
 REAR SPOILER W/LED LIGHT
 60" X 29" BAY WINDOW
 DOUBLE ROW LED INTERIOR CARGO LIGHTS
 PAINTED TWO TONE FIBERGLASS FRONT CAP
 GREY FIBERGLASS EXTERIOR
 GLASS CABINET DOOR IN GALLEY & BEDROOM
 ALUMINUM WALL CONSTRUCTION W/FIBERGLASS EXTERIOR
 BATHROOM DUCTED HEAT & A/C
 BATHROOM SKYLIGHT
 BEAVER TAIL I-BEAM CHASSIS
 BLACK FRAME TINTED SAFETY GLASS WINDOWS
 BLACK TANK FLUSH & OUTSIDE SHOWER
 ELECTRIC PASS THROUGH DINETTE
 CONVENIENCE CENTER IN BASEMENT
 UNDERMOUNT SINGLE BOWL CHEFS SINK W/LIDS
 BLACK CHEFS HIGH RISE SPRING FAUCET
 ELECTRIC 40" OR 54" SPORT BED
 KENWOOD TOUCH DVD PLAYER W/BLUETOOTH
 KENWOOD INTERIOR SPEAKERS (4) W/AMP PKG

KENWOOD MARINE GRADE EXT SPEAKERS (2)
 FAMILY MESSAGE CENTER
 3 BURNER COOK TOP W/GLASS COVER
 FLIPPED 6K OR 7K LB SUPER AXLES (PER F/P)
 2 CAPTAINS CHAIRS & 1 FOLD DOWN SOFA W/TABLE
 FRONT GRAVEL GUARD
 HEATED & ENCLOSED TANKS
 146 GALLONS FRESH WATER
 WIFI PREP & 7 WAY POWER CORD HOLSTER
 15K BTU DUCTED AIR CONDITIONER
 16" RADIAL TIRES (4)
 CEILING FAN WITH MEDALLION
 12.3 CU FT REFER (30, 32, & 34)
 BLACK ABS FENDER SKIRTS
 ELECTRIC BED STILE W/RECESSED LED LIGHTING
 8 CU FT REFER WITH O/H STORAGE CABINET (28 & 33)
 DIRECTIONAL BULLET LIGHTS IN BEDROOM
 GALLEY & LAVY BACKSPLASH
 LED EXTERIOR DUMPSTATION LIGHT
 WINDOW VALANCE
 MULTIPLE USB CHARGING STATIONS
 FLIP FLOOR CARGO SLIDE
 LIGHTED STORAGE COMPARTMENT
 LP QUICK CONNECT & DUEL 30# LP BOTTLES

1.6 CU FT MICROWAVE W/CAROUSEL
 BLACK NIGHT SHADES THROUGHOUT
 ONE PIECE SEAMLESS PVC WALK ON ROOF
 PORCELAIN FOOT FLUSH TOILET
 POWER AWNING
 POWER FRONT STAB JACKS
 GREY REAR RADIUS CARGO DOOR W/3,000 LB RATING
 RAMP DOOR SCARE LIGHTS & PORCH LIGHT
 22" GLASS FRONT OVEN
 STAINLESS STEEL APPEARANCE PACKAGE
 EXTERIOR TV OUTLET
 TRASH CAN STORAGE
 5.5 KW ONAN GEN W/50 AMP SERVICE & 2ND A/C PREP
 6 GAL QUICK RECOVERY G/E DSI WATER HEATER
 WARDROBE SLIDEOUT
 WIDE BODY CONSTRUCTION
 SEAMLESS TABLE AND LAVY TOPS
 LARGE BLACK MEDICINE CABINET
 FUEL STATION (35 GALLONS)
 FULLY INSULATED 2" FLOOR W/ 5/8" T&G
 TRANSFER SWITCH & BATTERY DISCONNECT
 RADIUS GLASS SHOWER
 OMNI DIRECTIONAL TV ANTENNA
 KITCHEN & BATH CROWN MOLDING
 SEWER HOSE CARRIER

COMFORT AND CONVENIENCE PACKAGE

ADD-A-WALL
 ENTRY SWING AWAY HANDLE
 MATCHING ALUMINUM SPARE TIRE
 RETRACTABLE ROOF LADDER
 WATER HEATER BYPASS

FIFTH WHEEL OPTIONS

BEDROOM A/C
 1,500 WATT "GO POWER" INVERTER
 EXTRA LARGE 28" LED TV (IN BEDROOM)
 39" LED TV IN LIVING AREA W/EXT MOUNT
 CARPET KIT
 TORKLIFT GLOW ENTRY STEPS (PRIMARY ENTRY)
 3 SEASON GLASS PATIO DOOR (30, 32, 34)
 RAMP DOOR PLAYPEN
 TOUGH PLY FLOORING
 TOYLOK DOOR SIDE
 ADDITIONAL 220W SOLAR PANEL
 ARCTIC PACKAGE - RADIANT FOIL INSULATION FLOOR & ROOF
 CREATE A BREEZE FAN (KITCHEN)

	28FWGDx	30FWGDx	32FWGDx	33FWGDx	34FWGDx
HITCH WEIGHT (LBS.)	2,210	2,416	2,616	2,458	2,604
GROSS VEHICLE WEIGHT RATING (LBS.)	14,210	14,999	14,999	14,999	14,999
UNLOADED VEHICLE WEIGHT (LBS.)	9,602	10,894	11,032	9,916	11,016
CARGO CARRYING CAPACITY (LBS.)	4,570	4,105	3,967	50,045	3,983
EXTERIOR LENGTH (FT.)	32' 6"	36' 5"	37' 10"	36' 6"	39' 3"
EXTERIOR HEIGHT (FT.)	13' 4"	13' 4"	13' 4"	13' 4"	13' 4"
FRESH WATER (GAL.)	140	140	140	140	140
GREY WATER (GAL.)	65	65	65	65	65
BLACK WATER (GAL.)	40	40	40	40	40

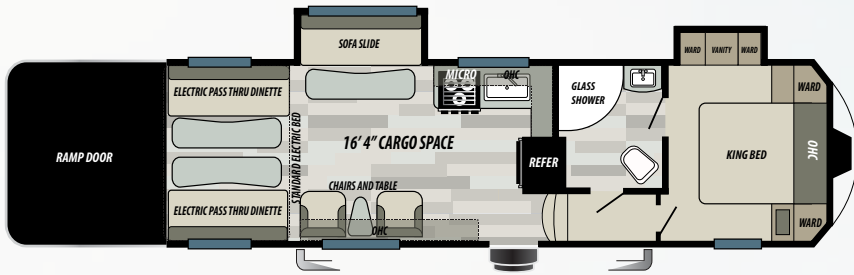

28FWGDX

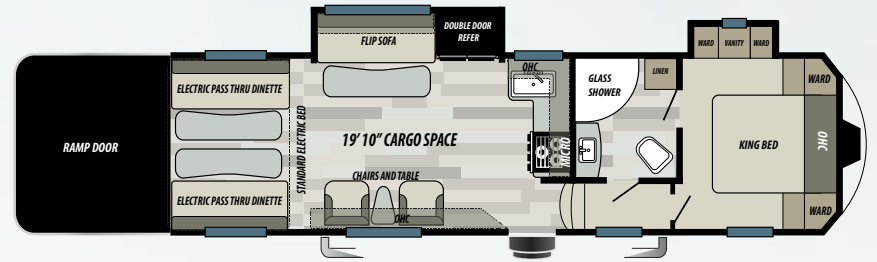

30FWGDX

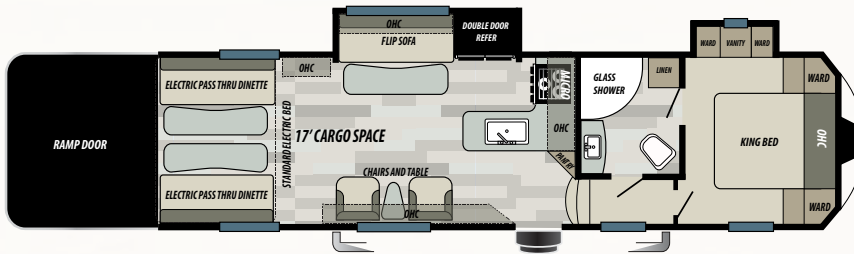

32FWGDX

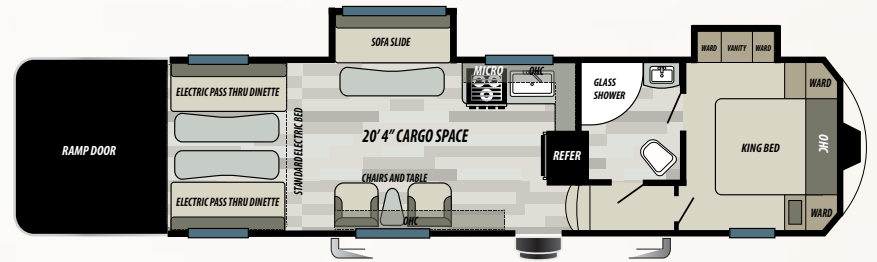

33FWGDX

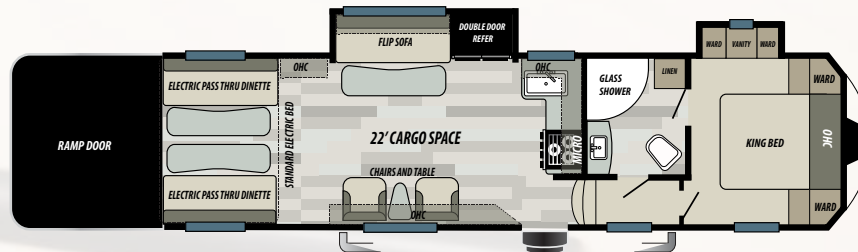

34FWGDX



FREE MEMBERSHIP
to Forest River Owners' Group



www.forestriverfrog.com



Learn More
Scan this barcode using
a QR Reader on your
smart phone to learn
more about Forest River.



A Berkshire Hathaway company.

FOREST RIVER INC., 255 S PEPPER AVE RIALTO, CA 92376 | (909) 873-3777
WWW.FORESTRIVERINC.COM/SHOCKWAVE | WWW.FORESTRIVERACCESSORIES.COM
 EFFECTIVE UNITS BUILT AFTER 3/1/2020

CUSTOMER SATISFACTION



www.ForestRiverBuyLocal.com

YOUR SHOCKWAVE DEALER

LaMESA REC VAN

LaMesaRV.com
800-496-8778

Specification Definitions

GVWR (Gross Vehicle Weight Rating) - is the maximum permissible weight of the unit when fully loaded. It includes all weights, inclusive of all fluids, cargo, optional equipment and accessories. For safety and product performance do NOT exceed the GVWR.

GAWR (Gross Axle Weight Rating) - is the maximum permissible weight, including cargo, fluids, optional equipment and accessories that can be safely supported by a combination of all axles.

UVW (Unloaded Vehicle Weight)* - is the typical weight of the unit as manufactured at the factory. It includes all weight at the unit's axle(s) and tongue or pin and LP Gas. The UVW does not include cargo, fresh potable water, additional optional equipment or dealer installed accessories.

*Estimated average based on standard build optional equipment.

All information contained in this brochure is believed to be accurate at the time of publication. However, during the model year, it may be necessary to make revisions and Forest River, Inc., reserves the right to make all such changes without notice, including prices, colors, materials, equipment and specifications as well as the addition of new models and the discontinuance of models shown in this brochure. Therefore, please consult with your Forest River dealer and confirm the existence of any materials, design or specifications that are material to your purchase decision. Litho. U.S.A. FOR 1420 P/W: 2020.3.1

CCC (Cargo Carrying Capacity)** - is the amount of weight available for fresh potable water, cargo, additional optional equipment and accessories. CCC is equal to GVWR minus UVW. Available CCC should accommodate fresh potable water (8.3 lbs per gallon). Before filling the fresh water tank, empty the black and gray tanks to provide for more cargo capacity. ** Estimated average based on standard build optional equipment

Each Forest River RV is weighed at the manufacturing facility prior to shipping. A label identifying the unloaded vehicle weight of the actual unit and the cargo carrying capacity is applied to every Forest River RV prior to leaving our facilities. The load capacity of your unit is designated by weight, not by volume, so you cannot necessarily use all available space when loading your unit.